

PROJECT: HARMON ADDITION
OWNER: DONALD & TIFFANY HARMON
PROJECT ADDRESS: 601 YELLOWSTONE RD
PARCEL: 767835, 22-11-090011-0007
ACRES: 0.43
ZONE: PUD LAMRID TYPE 1 RESIDENTIAL
GROUND
SNOW LOAD Pg: 252
SEISMIC ZONE: D1
MUI ZONE: IR 1
SETBACKS:
FRONT: 15'
SIDE: 5'
REAR: 15'

RECEIVED
 NOV 16 2022
 Kittitas County CDS

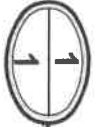
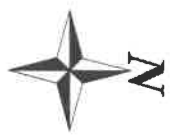
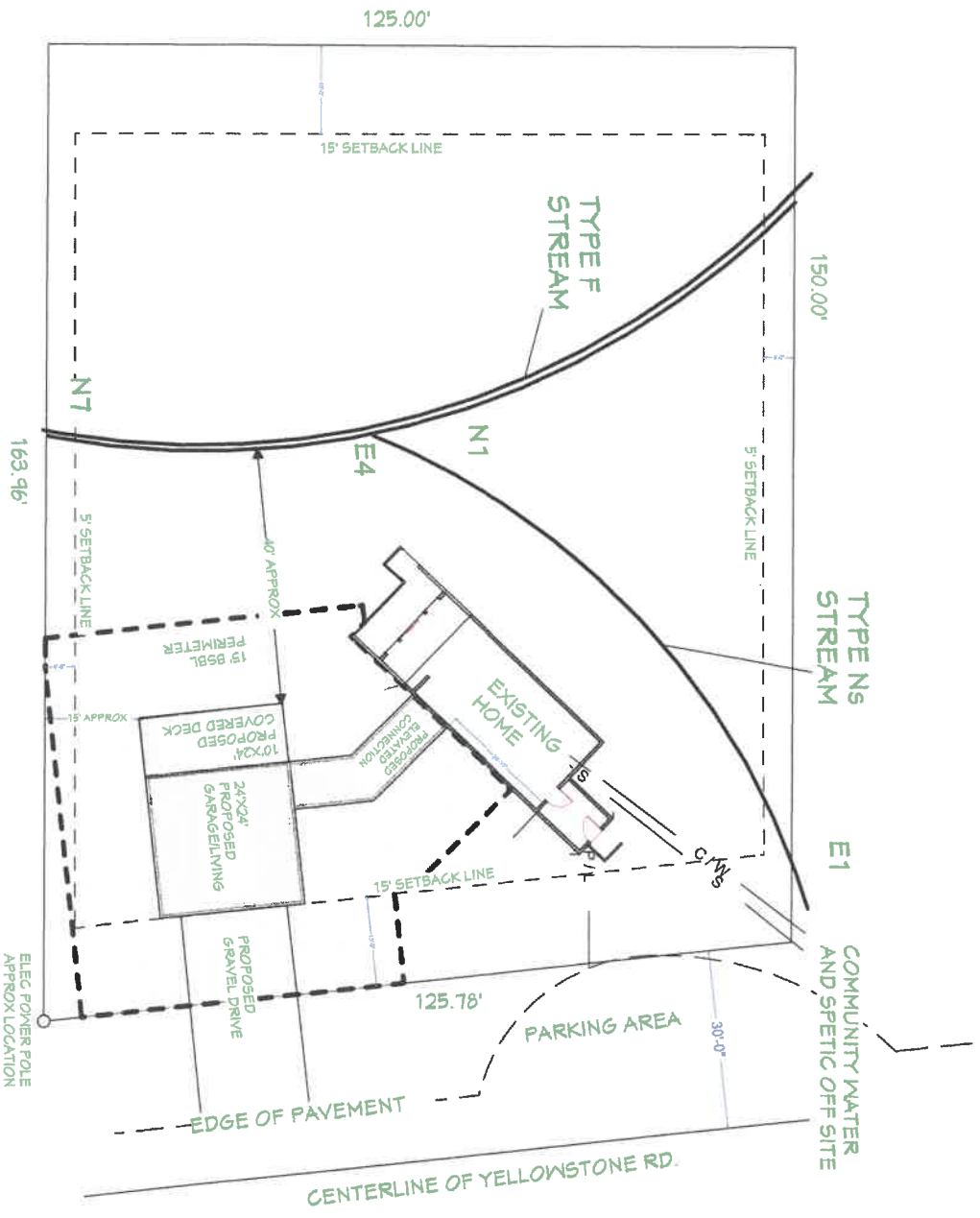

SITE PLAN SCALE 1" = 30'
 SCALE: 1" = 30'

FOOTPRINT OF NEW CONST: 1032 SQ.FT.
BSBL 15' PERIMETER AREA: 2860 SQ.FT.
BSBL PLUS CONST AREA: 3892 SQ.FT.

COPYRIGHTED BY ALPINE DESIGN & INSPECTION, INC. THIS DRAWING IS NOT TO BE USED TO CONSTRUCT MORE THAN ONE BUILDING AT THE SITE LISTED OR ANY OTHER WITHOUT WRITTEN PERMISSION FROM THE COPYRIGHT HOLDER.

HARMON	PARCEL#: 767835	601 YELLOWSTONE RD SNOQUALMIE SUMMIT	SITE PLAN		1/1	
			OCTOBER 2022	NO SCALE		